

State of Wyoming Corner Record

(In compliance with the CORNER PERPETUATION AND FILING ACT, Wyoming Statutes, 1997 Section 33-29-140 et. seq., and the Rules and Regulations of the Board of Professional Engineers and Professional Land Surveyors)

Reverse side of this form may be used if more space is needed.

Record of original survey and citation of source of historical information (if corner is lost or obliterated). Description of corner monumentation evidence found and/or monument and accessories established to perpetuate the location of this corner. Sketch of relative location of monument, accessories, and reference points with course and distance to adjacent corner(s) (if determined in this survey). Method and rationale for reestablishment of lost or obliterated corner.

ORIGINAL CALL FOR 6" X 7' PINE POST IN 6' X 3' MOUND, 18" PINE BT N45°E, 95 LINKS,
 18" PINE BT S35°E, 2 CHAINS 40 1/2 LINKS.
 FOUND 6" X 5' POST IN MOUND OF STONES WITH 41 NL 1873 SCRIBED ON FACE. ALSO FOUND
 30" PONDEROSA W/ SCRIBED BLAZE FALLEN SW, AND 28" LODGE POLE W/ SCRIBED BLAZE ON NW
 FACE.
 SET 3/4" X 30" REBAR WITH 3 1/4" ALUMINUM CAP AT BASE OF FALLEN POST AND REBUILT MOUND
 OF STONES.
 SET 5/8" X 24" REBARS WITH 1 1/2" ALUMINUM CAPS P.L.S. 6099 FOR TIES AS SHOWN
 BELOW.

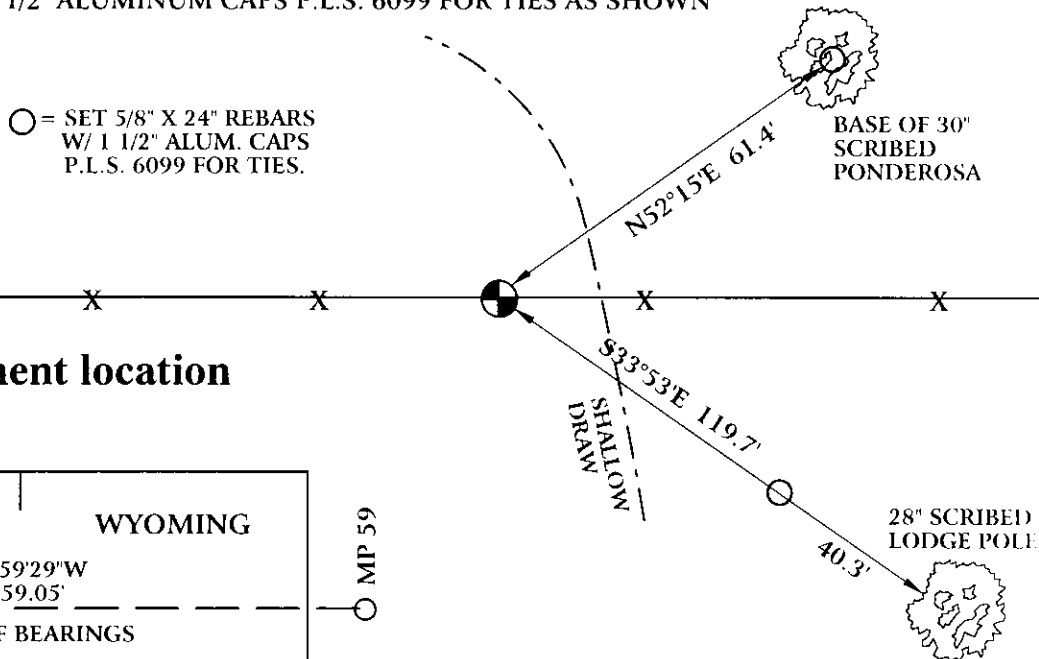

Monument location

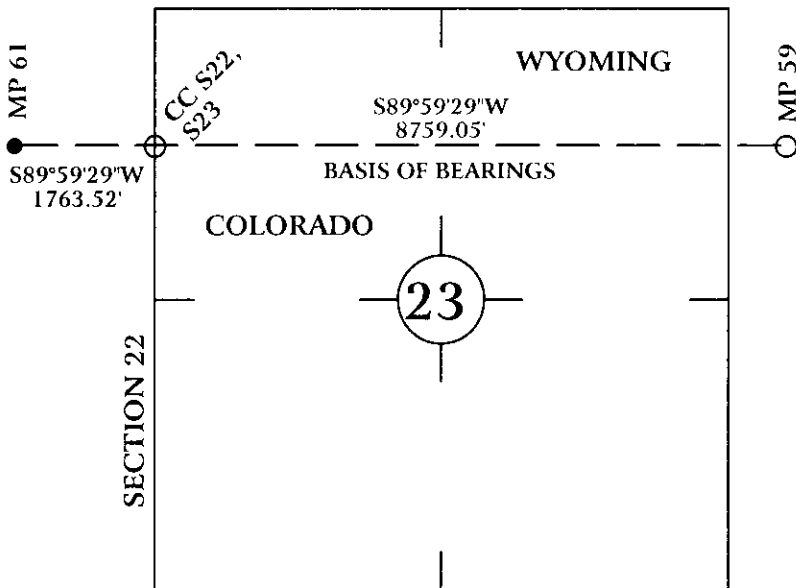

Monument Inscription

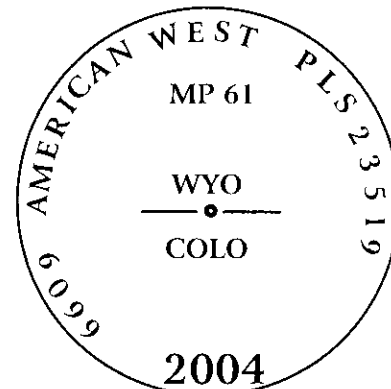

3/4" X 30" REBAR WITH
 3 1/4" ALUMINUM CAP.
 P.L.S. 6099

Date of Field Work: 10/8/04

Office Reference: AW04-8634

Cross Index Plat

	1	2	3	4	5	6	7	8	9	10	11	12	13	14	15	16	17	18	19	20	21	22	23	24	25
A																									
B																									
C	6	5	4	3	2	1																			
D																									
E																									
F																									
G	7	8	9	10	11	12																			
H																									
I																									
J																									
K	18	17	16	15	14	13																			
L																									
M																									
N																									
O																									
P	19	20	21	22	23	24																			
Q																									
R																									
S																									
T																									
U	30	29	28	27	26	25																			
V																									
W																									
X	31	32	33	34	35	36																			
Y																									
Z																									

Firm/Agency, Address
 CHARLES H. RUSSELL P.L.S. 6099
 AMERICAN WEST LAND SURVEYING CO.
 29 SOUTH 4TH AVENUE
 BRIGHTON, CO 80601

Telephone Number:
 303-659-1532

This corner record was prepared
 by me or under my direction
 and supervision.

SEAL & SIGNATURE



RECORDED 2/17/2005 AT 1:51 PM REC# 409608 BK# 1065 PG# 148
 DEBRA K. LATHROP, CLERK OF LARAMIE COUNTY, WY PAGE 1 OF 1

Corner Name Colo. / Wyo. MP 61, Section 22, T 12 N, R 70 W, 6th P.M.

Cross-Index No.: O-15-16

County: Laramie Wyoming / Larimer Colorado

SBRPEPLS/PLSW: March 1994; PLSW January 1998